



US 20170245884A1

(19) **United States**

(12) **Patent Application Publication**
Torrie

(10) **Pub. No.: US 2017/0245884 A1**

(43) **Pub. Date: Aug. 31, 2017**

(54) **MULTIPLE PORTAL GUIDE**

Publication Classification

(71) Applicant: **Smith & Nephew, Inc.**, Memphis, TN (US)

(51) **Int. Cl.**
A61B 17/34 (2006.01)
A61B 1/00 (2006.01)
A61B 17/17 (2006.01)
A61B 90/11 (2006.01)

(72) Inventor: **Paul Alexander Torrie**, Marblehead, MA (US)

(52) **U.S. Cl.**
CPC *A61B 17/3403* (2013.01); *A61B 90/11* (2016.02); *A61B 1/00154* (2013.01); *A61B 17/175* (2013.01); *A61B 17/3421* (2013.01); *A61B 2017/00477* (2013.01)

(73) Assignee: **Smith & Nephew, Inc.**, Memphis, TN (US)

(21) Appl. No.: **15/593,100**

(22) Filed: **May 11, 2017**

(57) **ABSTRACT**

Related U.S. Application Data

The present disclosure relates to a guide assembly. The guide assembly includes a guide having a body having a first set of marks and a joint including at least one through hole, the joint configured for sliding along the length of the body; and a first surgical device having a second set of marks, wherein the guide is coupled to the first surgical device and a longitudinal axis of the through hole is co-radial with a mark of the second set of marks when the joint is located at a mark of the first set of marks. Other guides are also disclosed.

(63) Continuation of application No. 12/794,142, filed on Jun. 4, 2010, which is a continuation-in-part of application No. 12/032,168, filed on Feb. 15, 2008, now Pat. No. 8,956,278.

(60) Provisional application No. 61/015,811, filed on Dec. 21, 2007, provisional application No. 61/187,797, filed on Jun. 17, 2009.

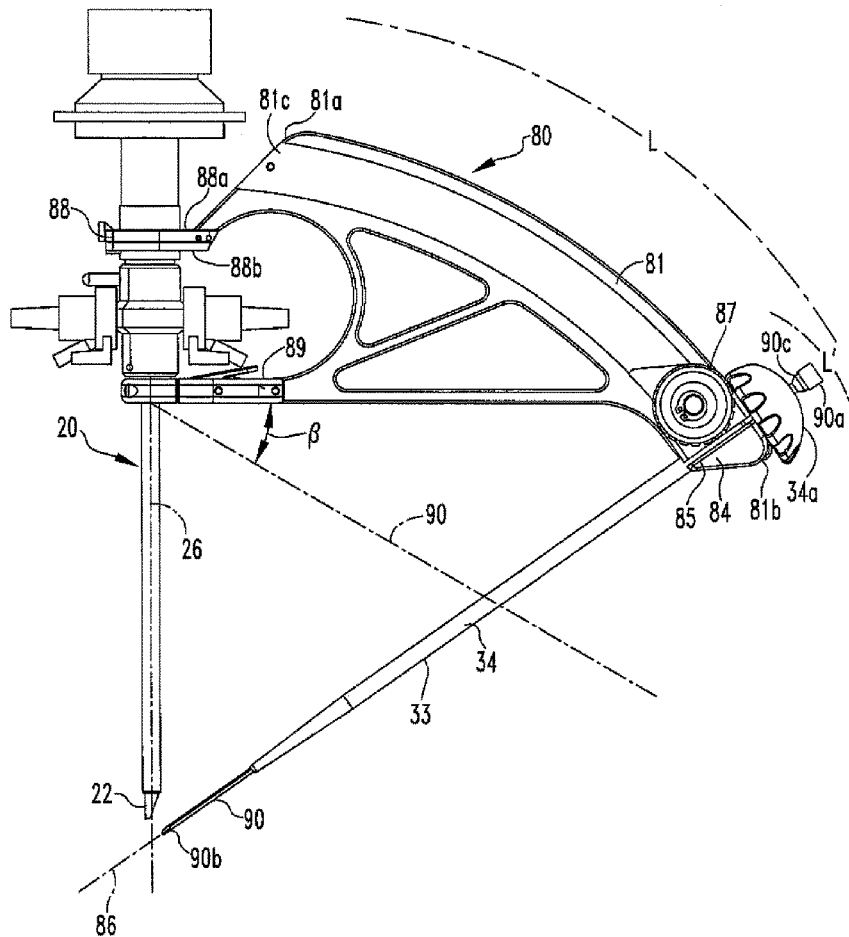

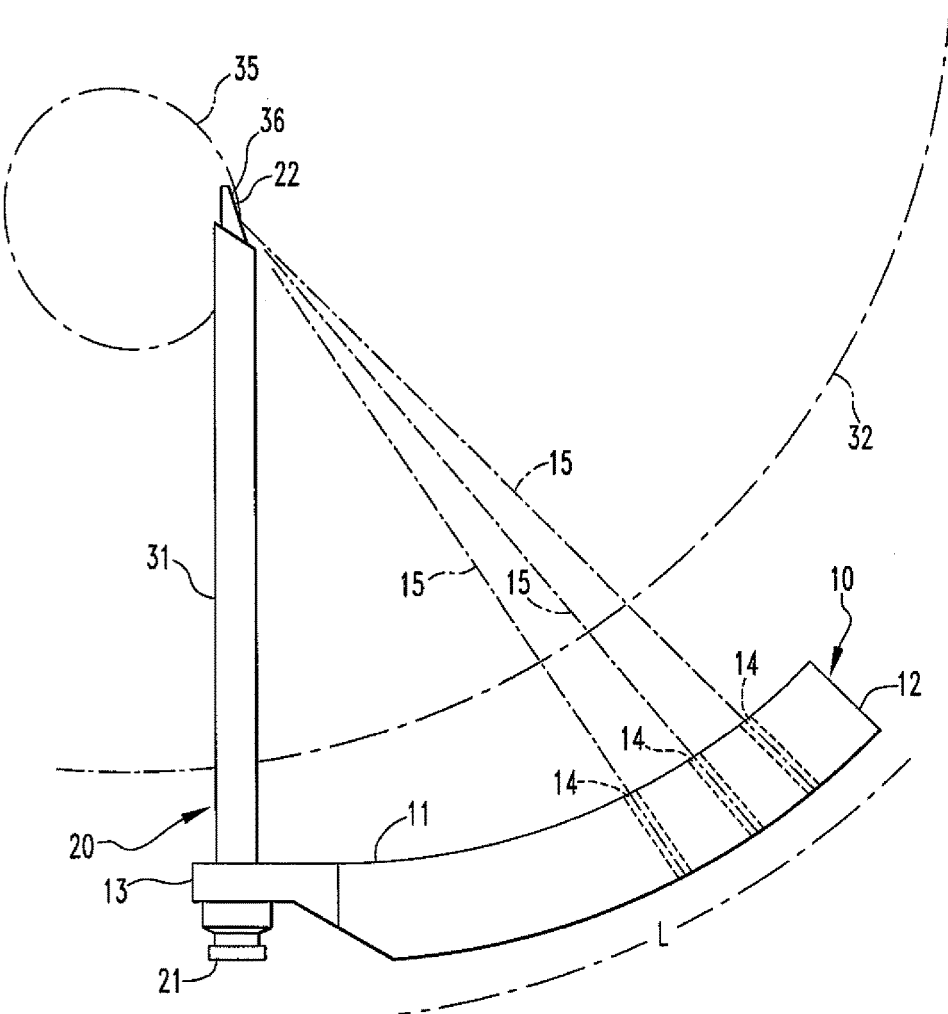

FIG.1

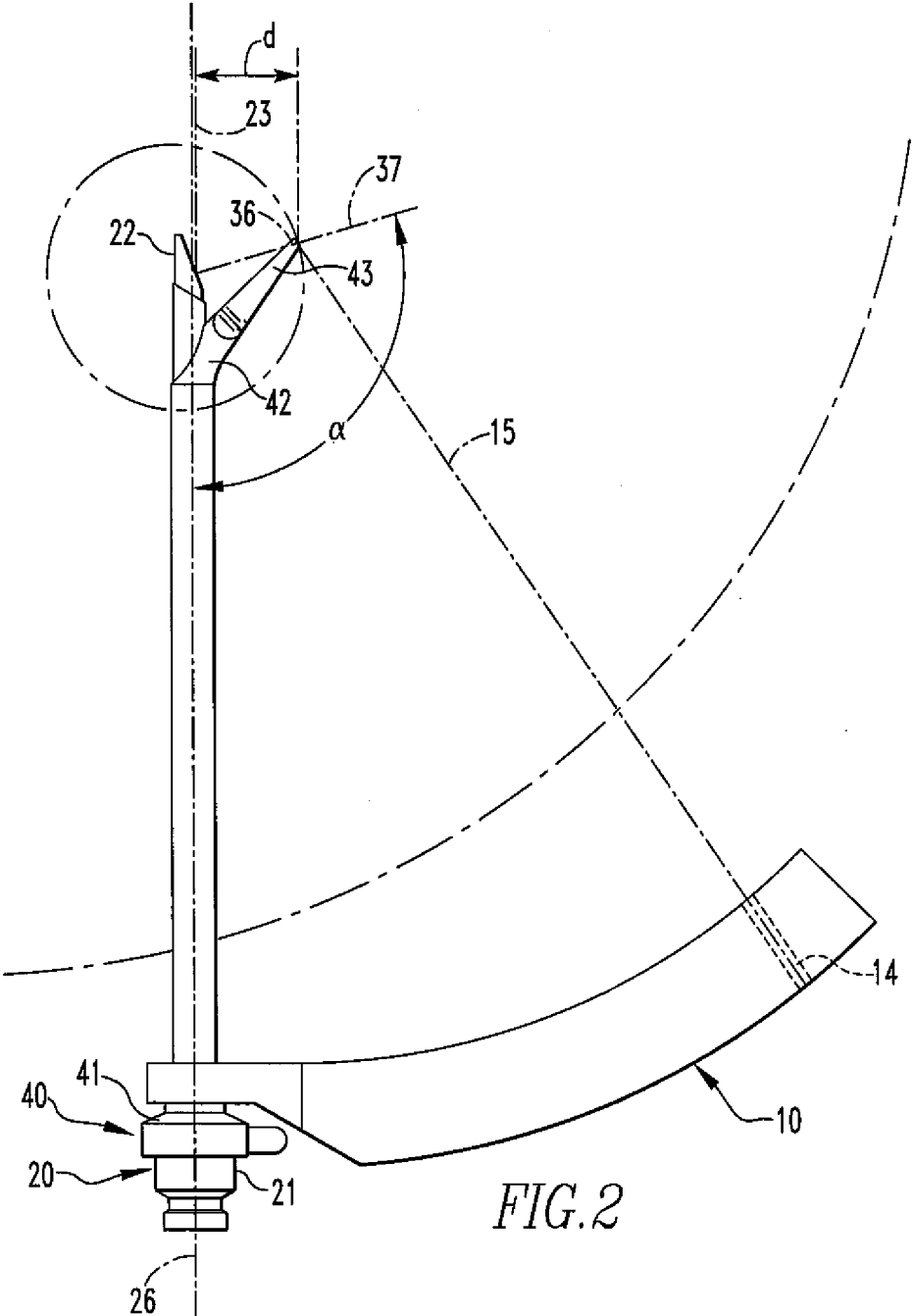

FIG. 2

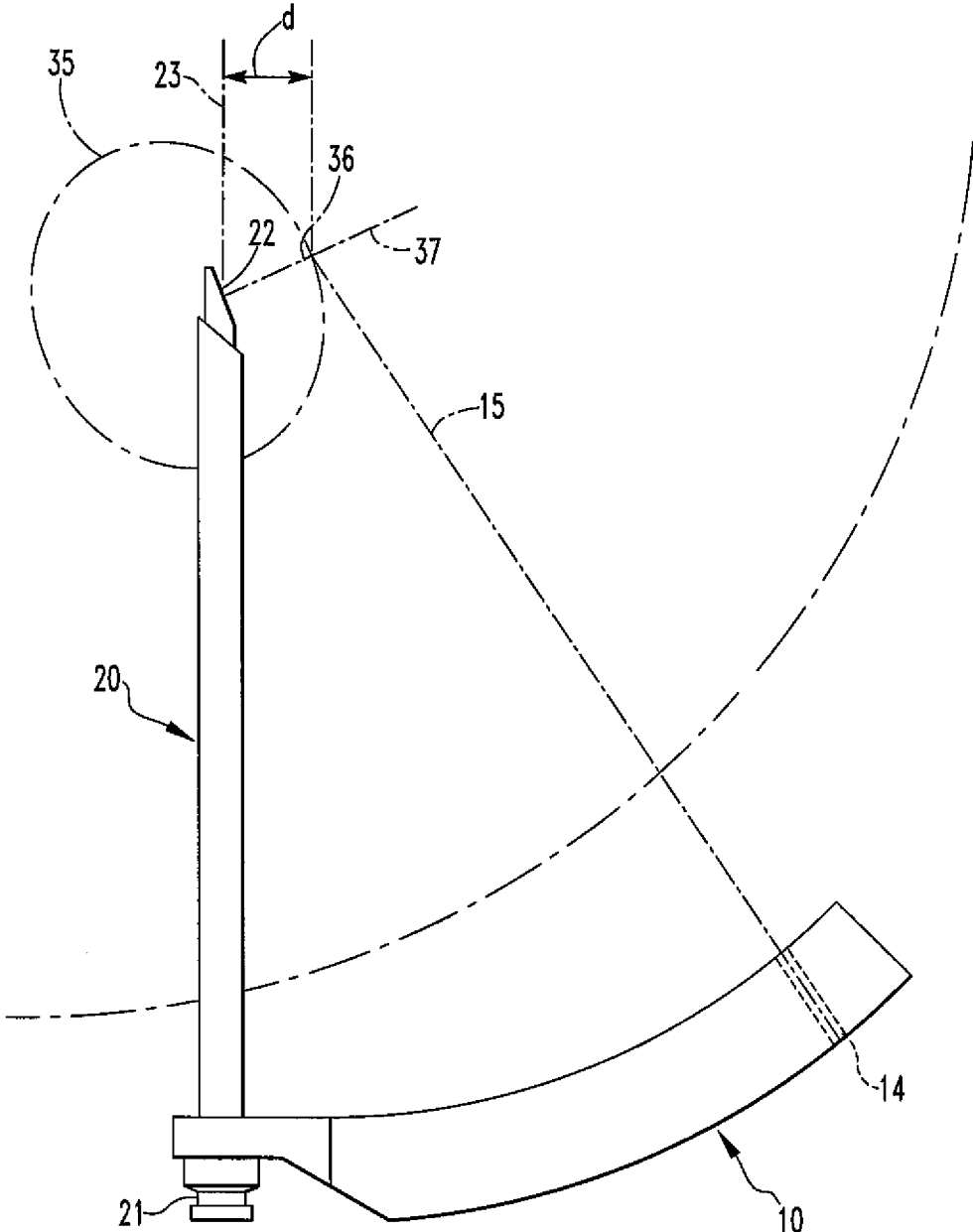

FIG. 3

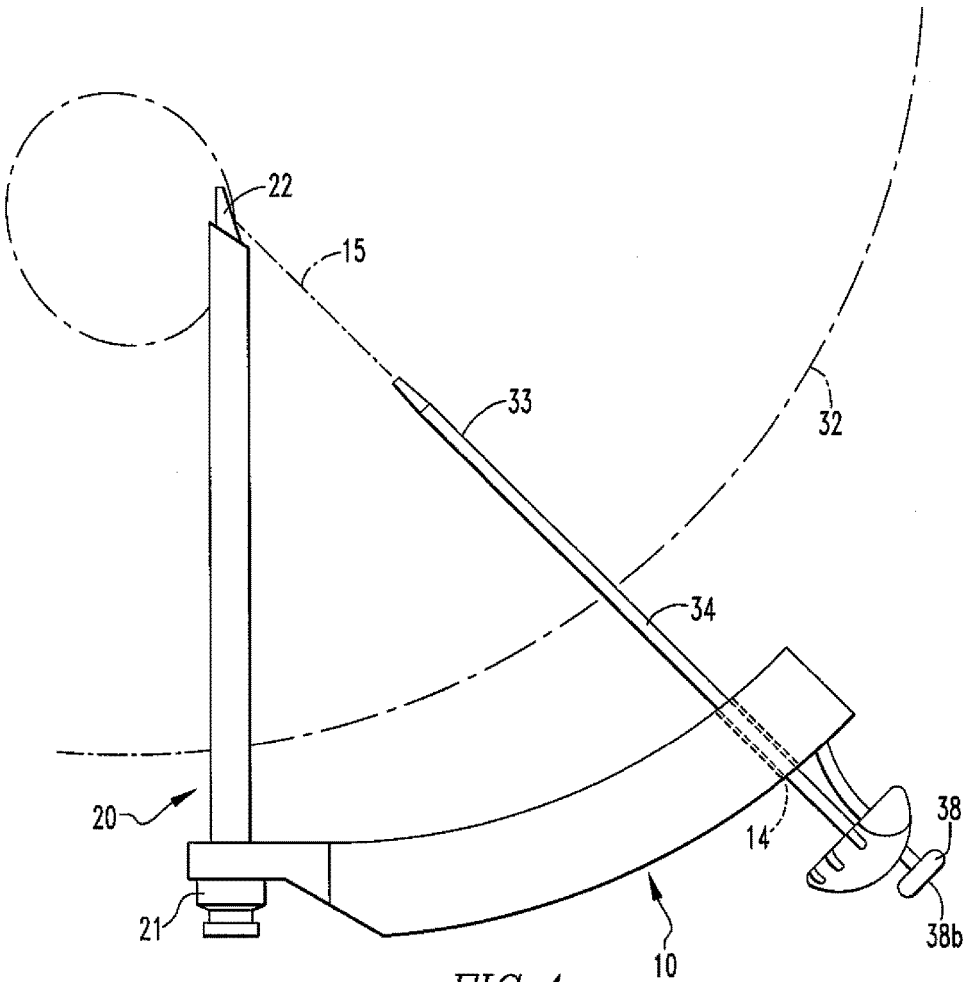

FIG. 4

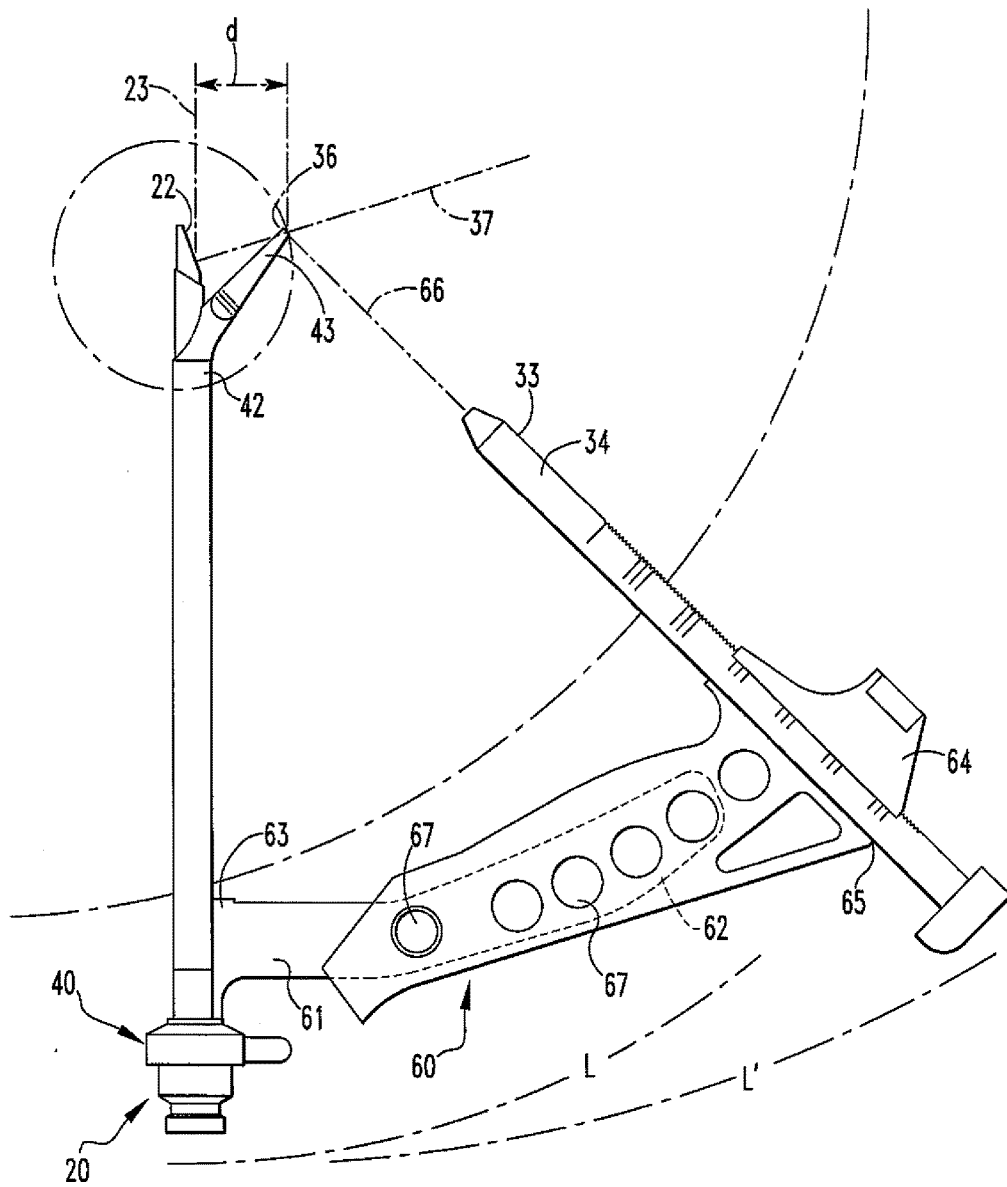

FIG. 5

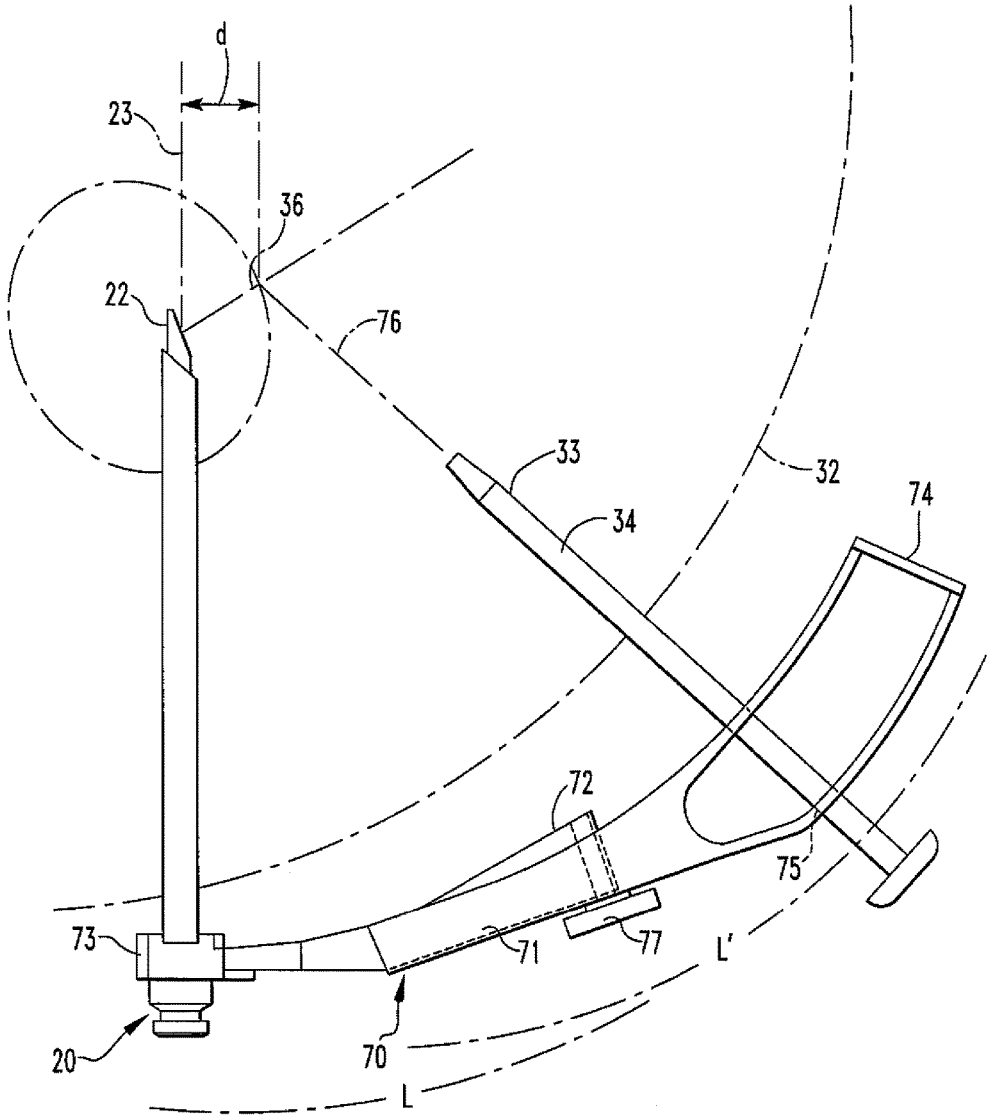

FIG. 6

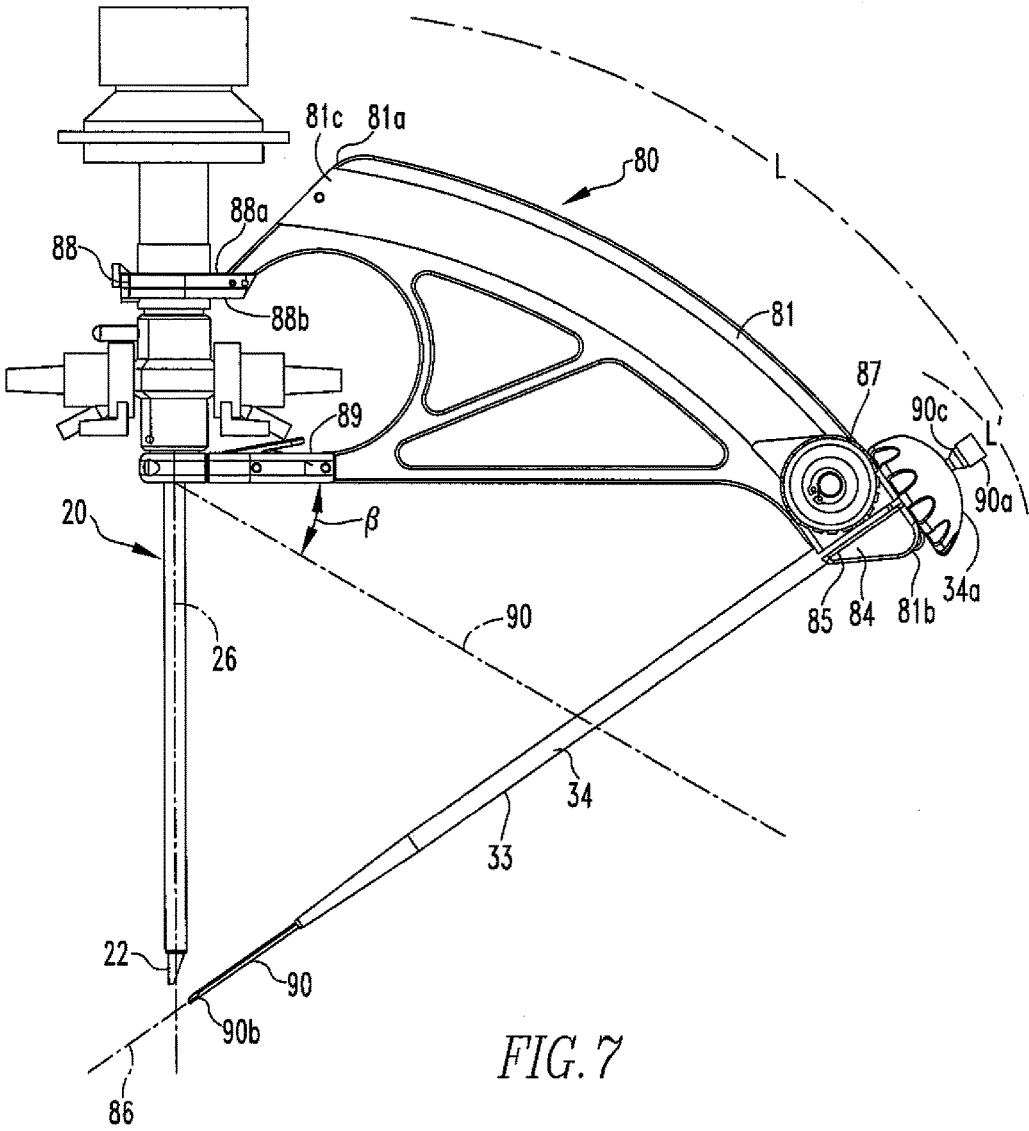

FIG. 7

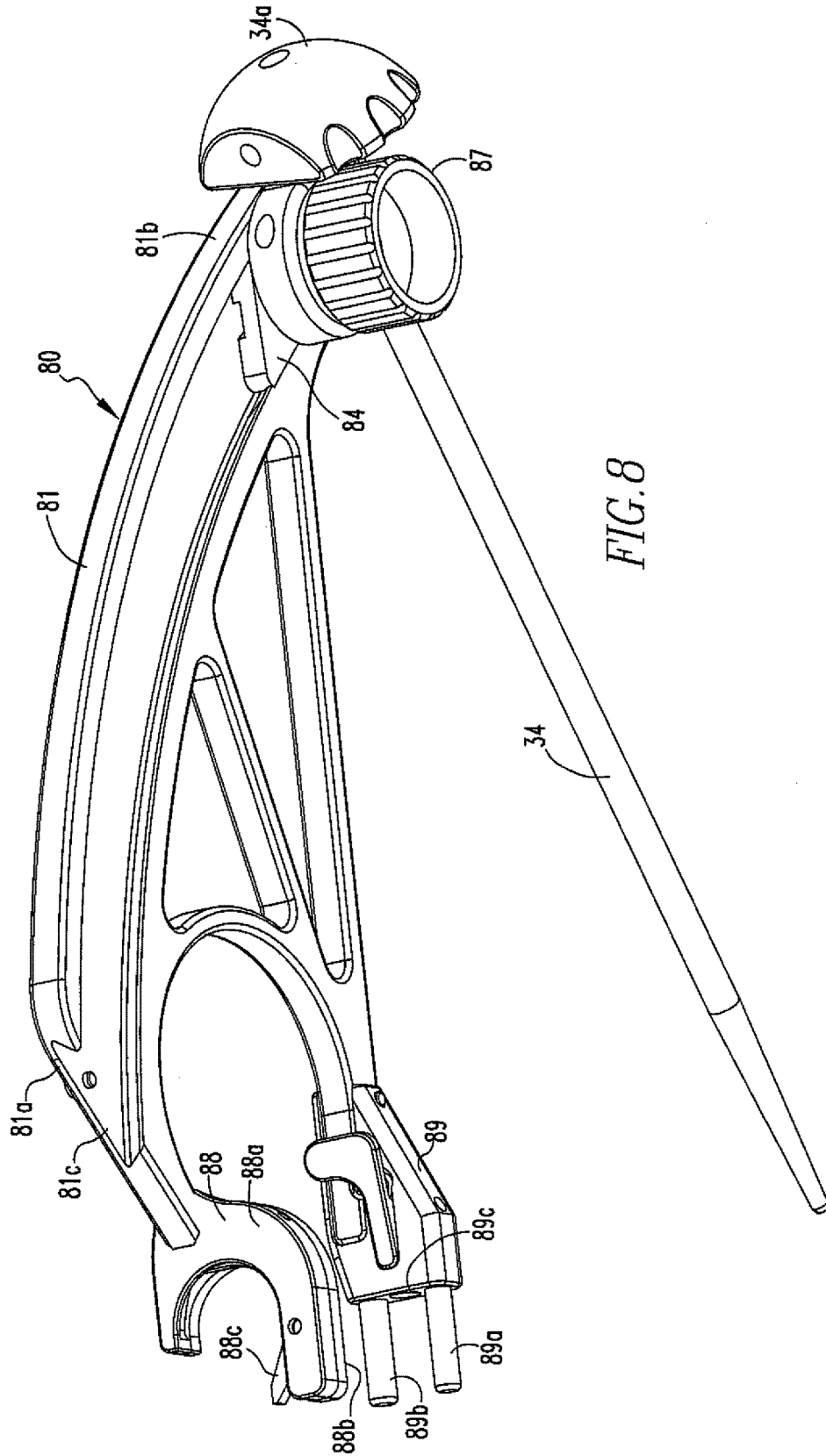
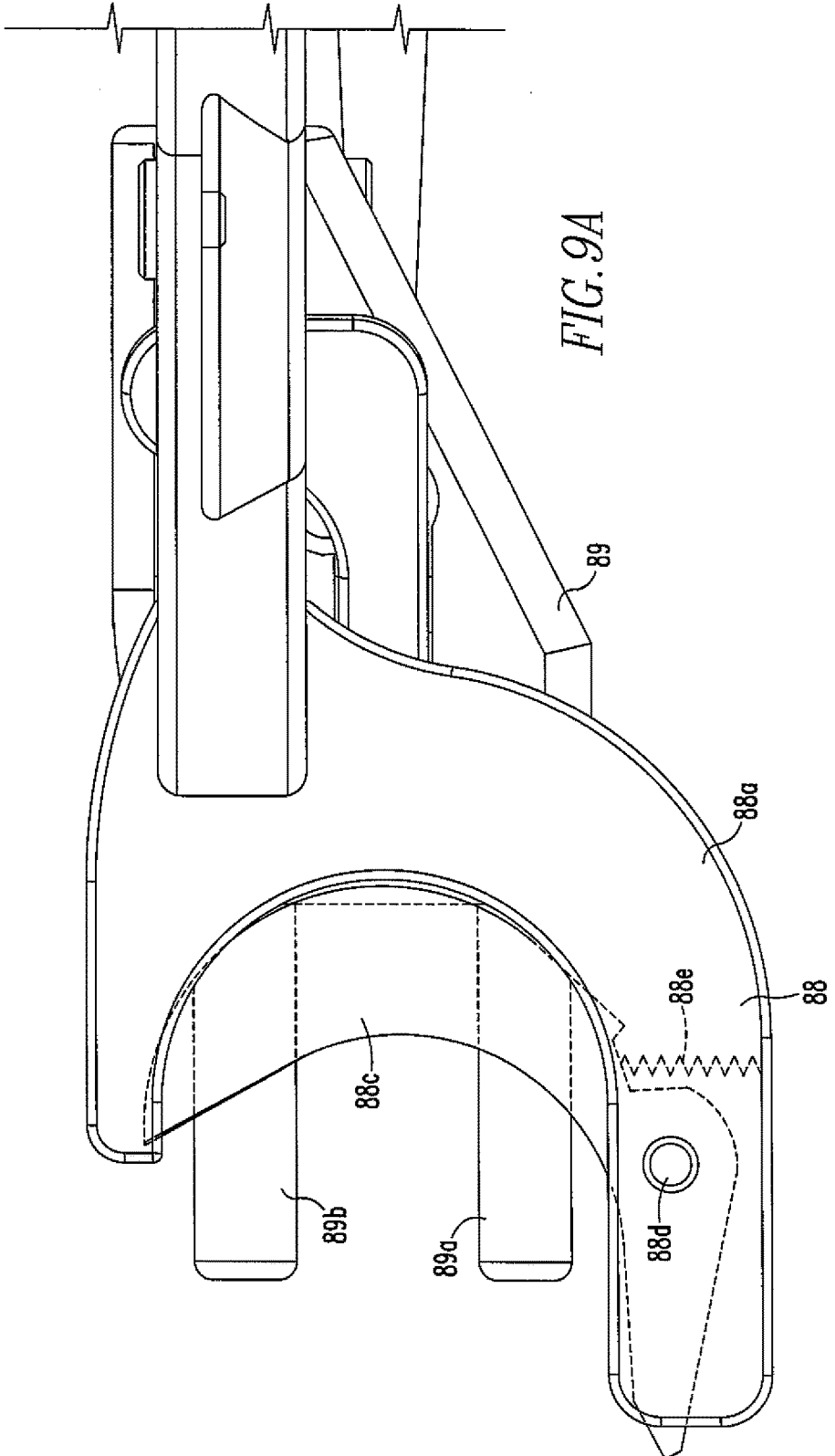
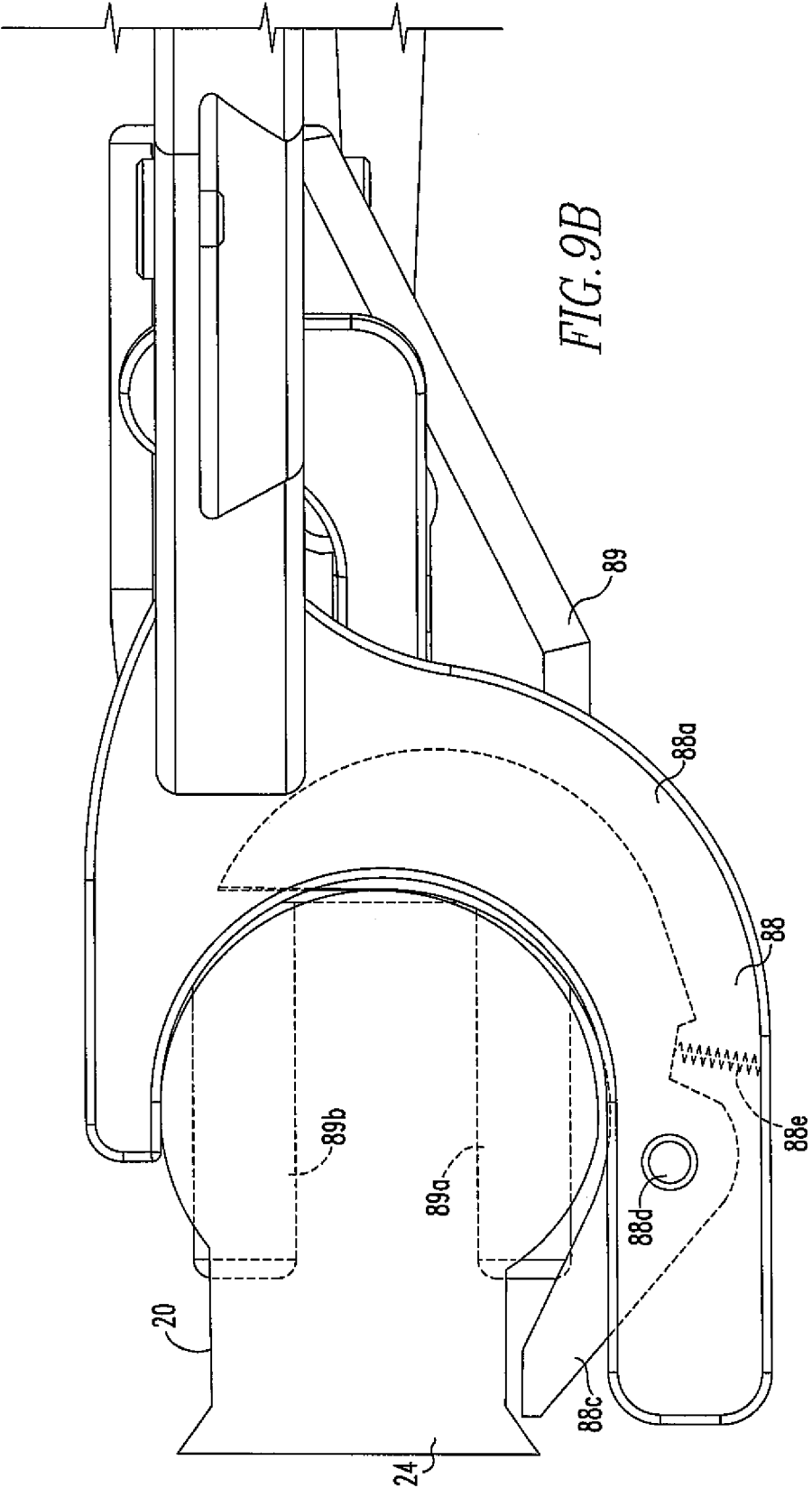

FIG. 8





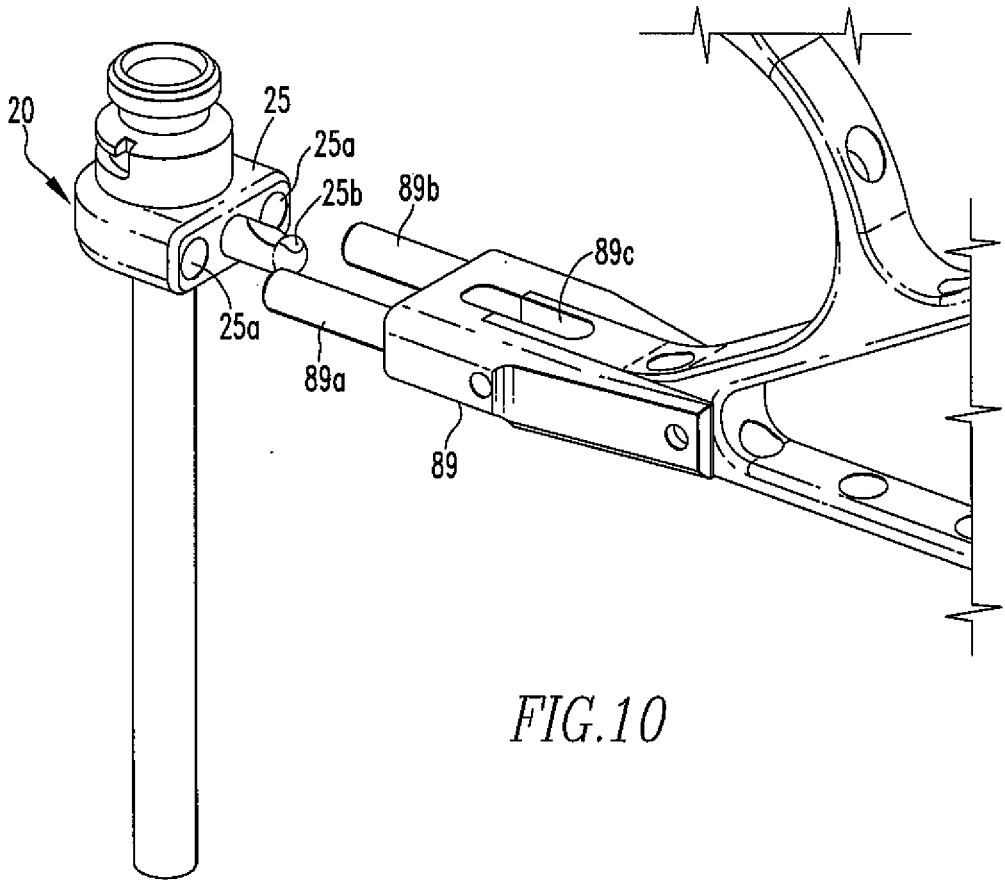

FIG. 10

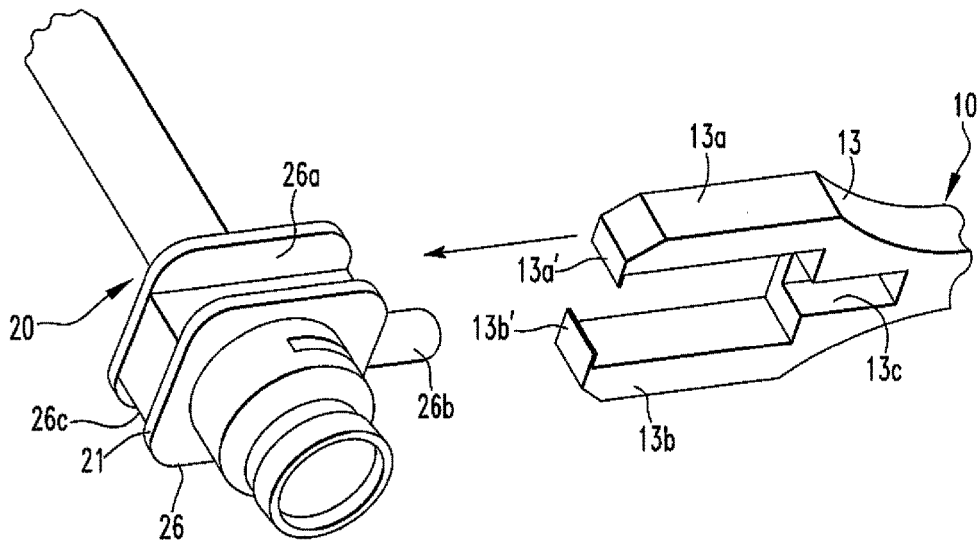

FIG.11A

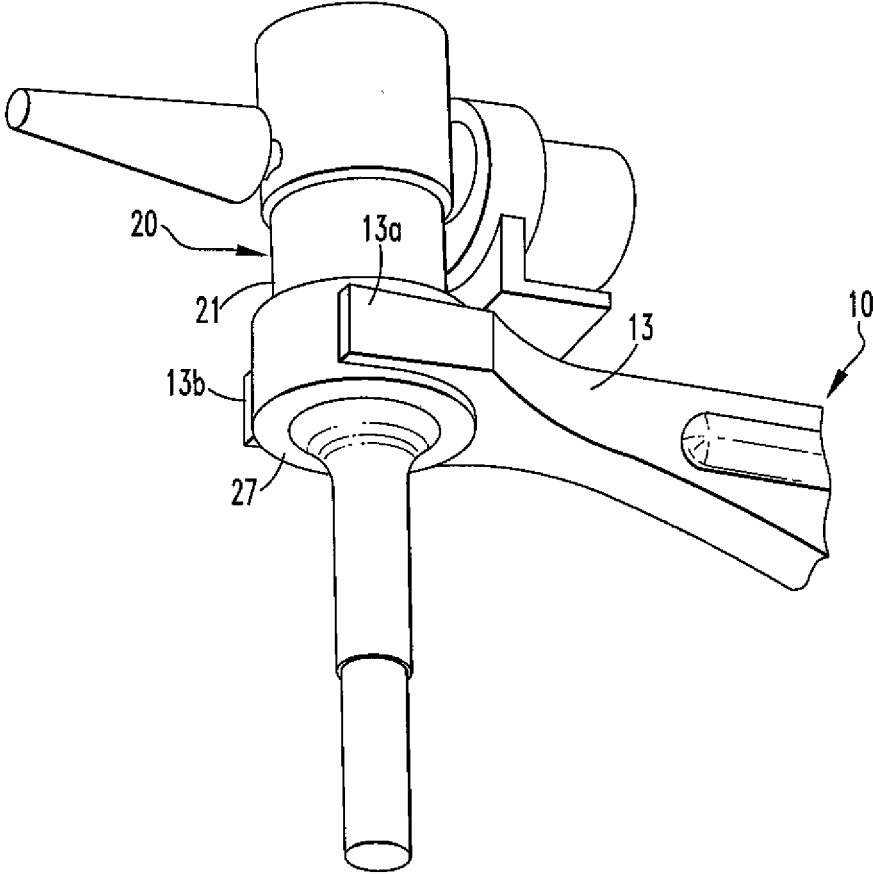

FIG. 11B

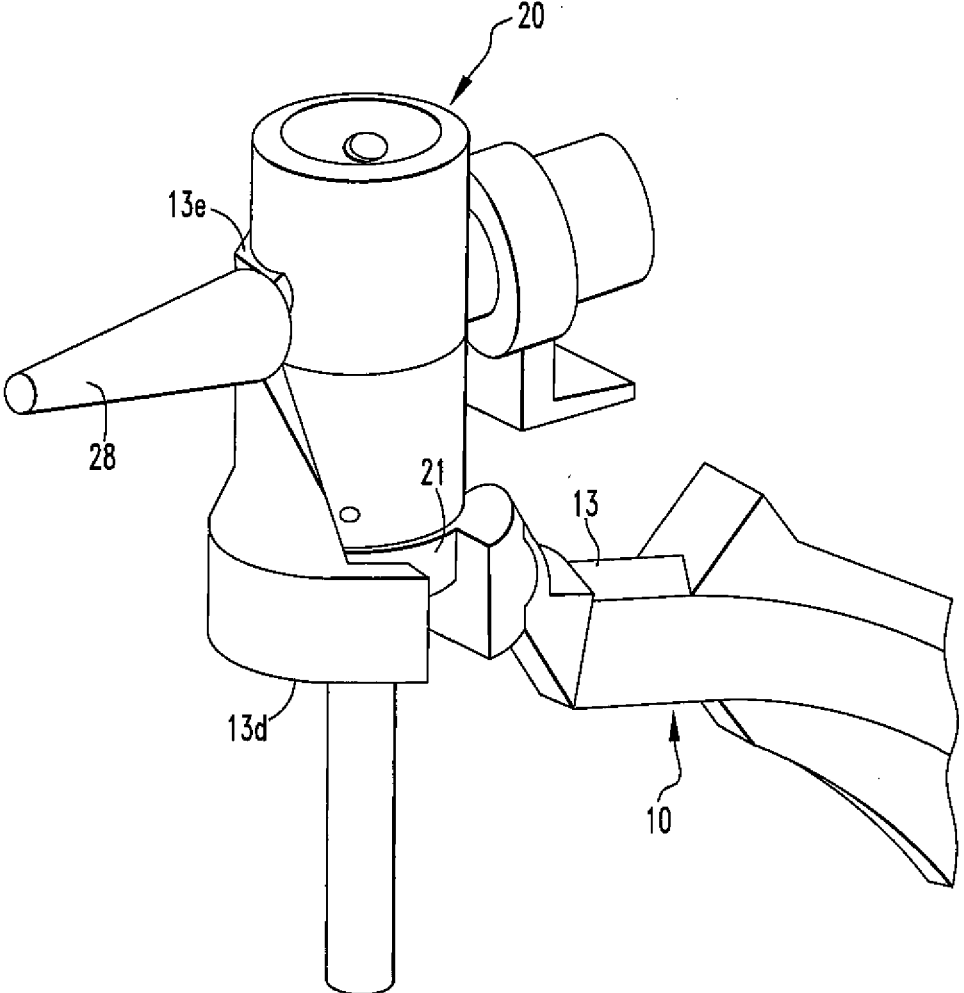

FIG.11C

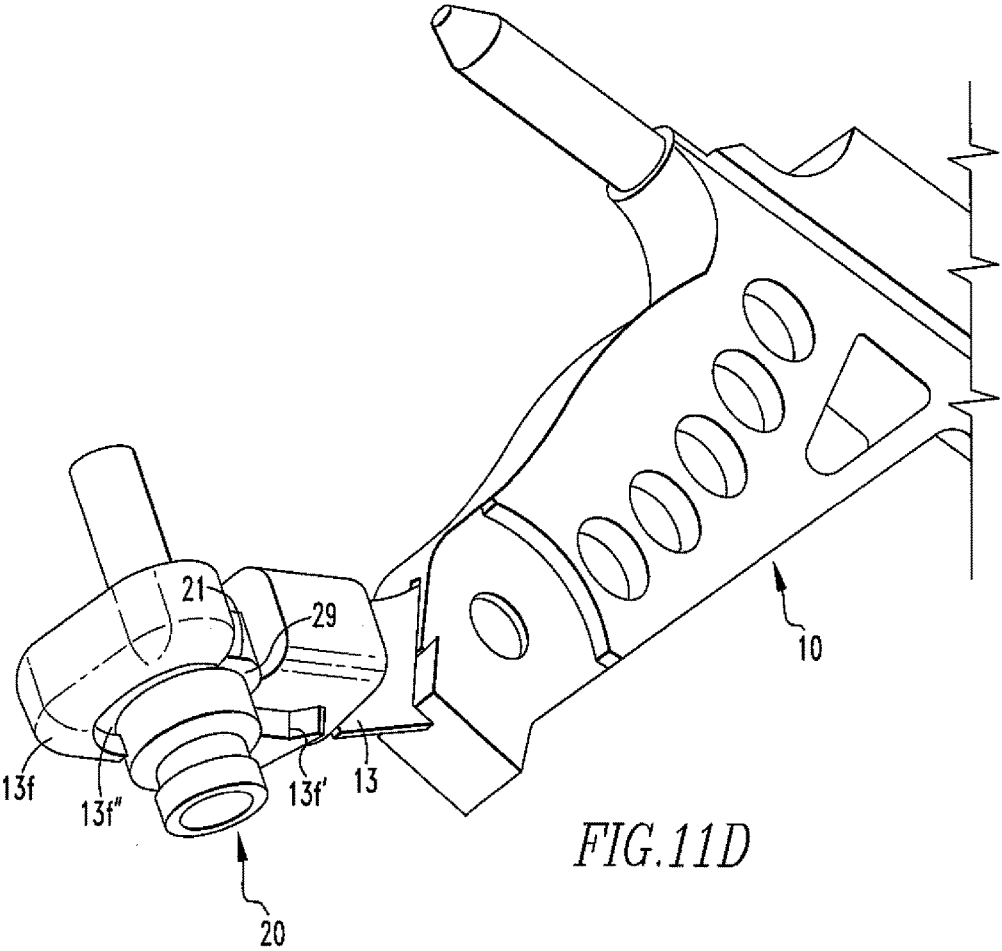
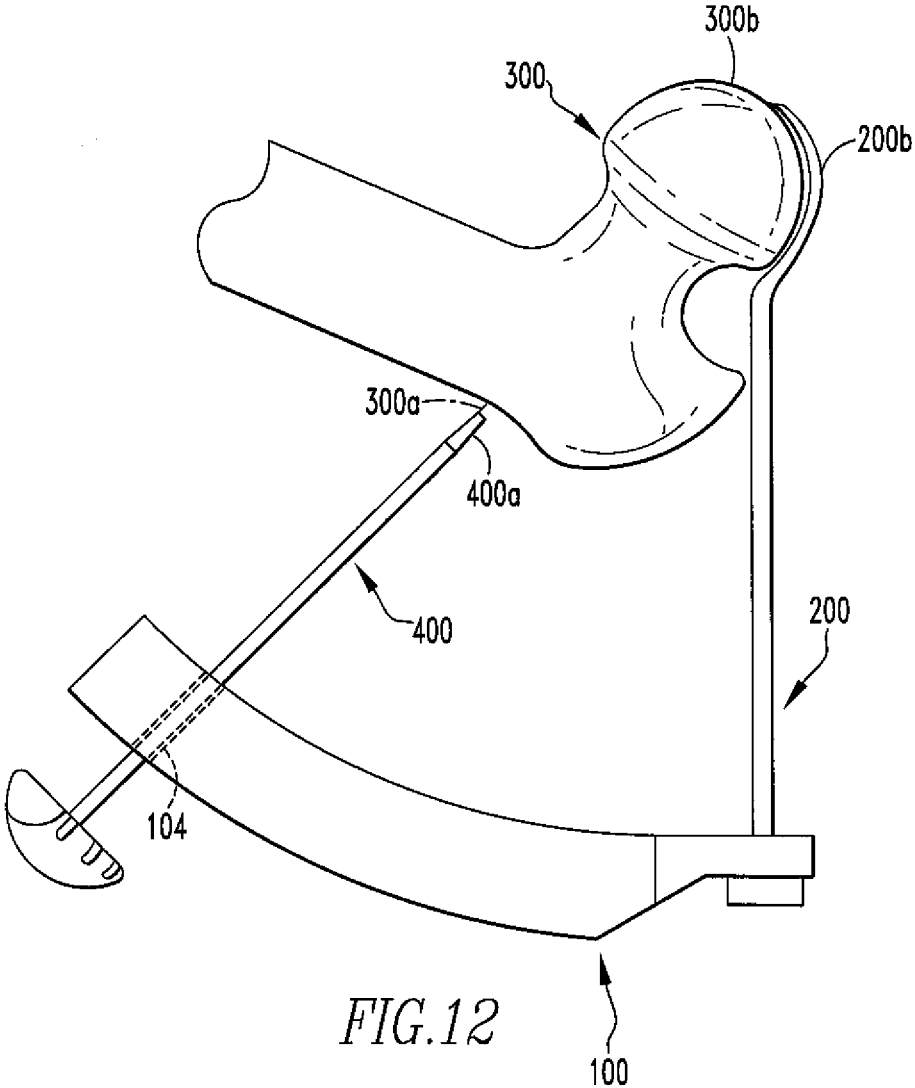

FIG. 11D



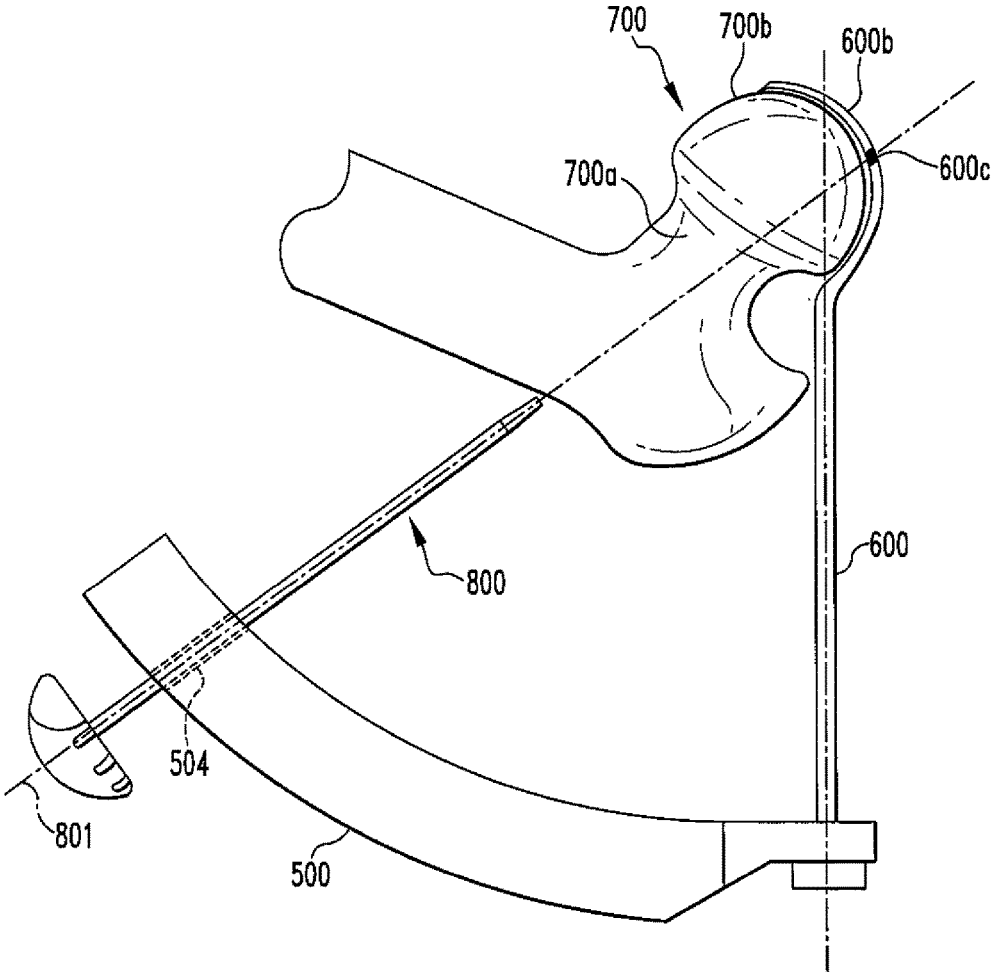
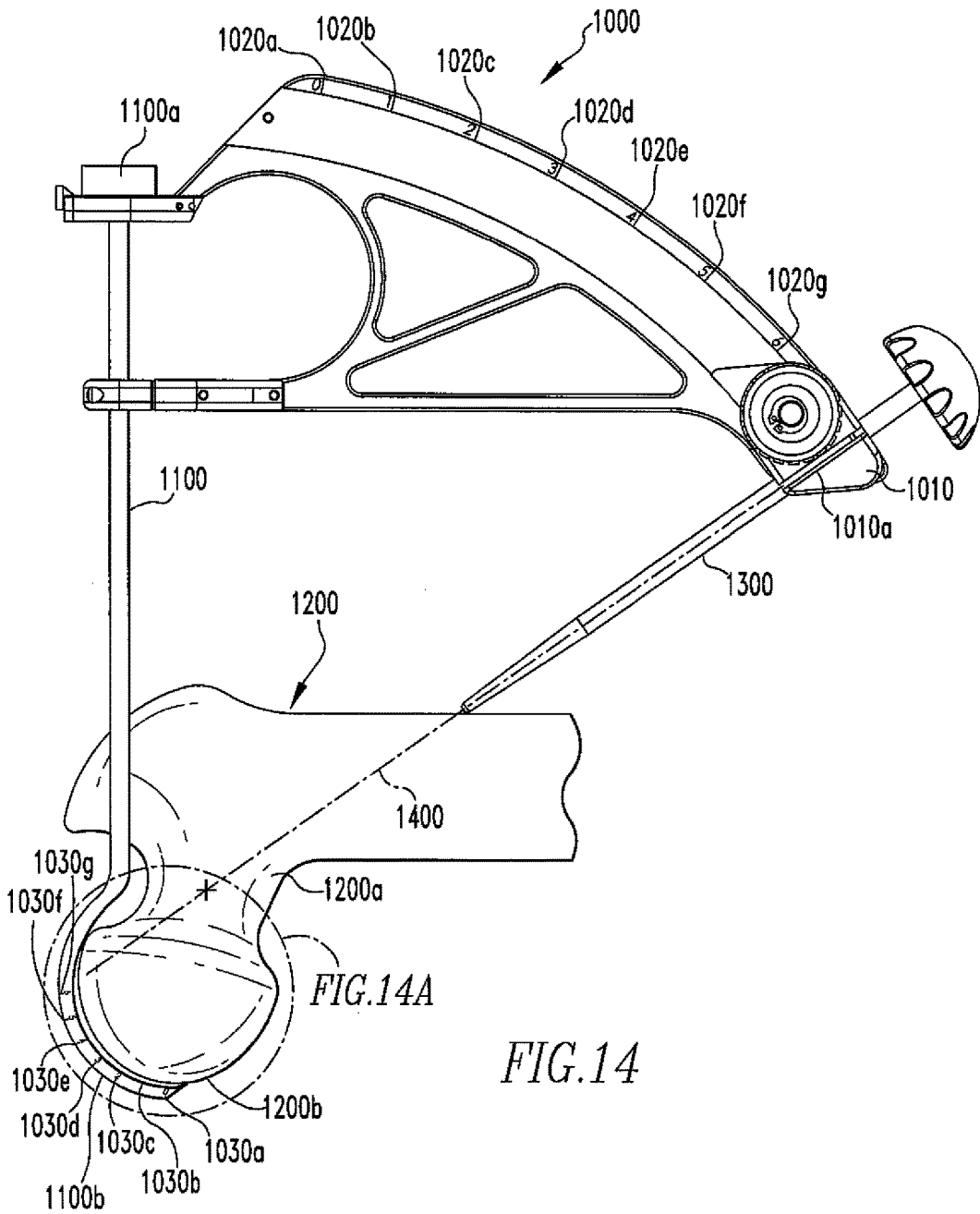

FIG.13

not finalized



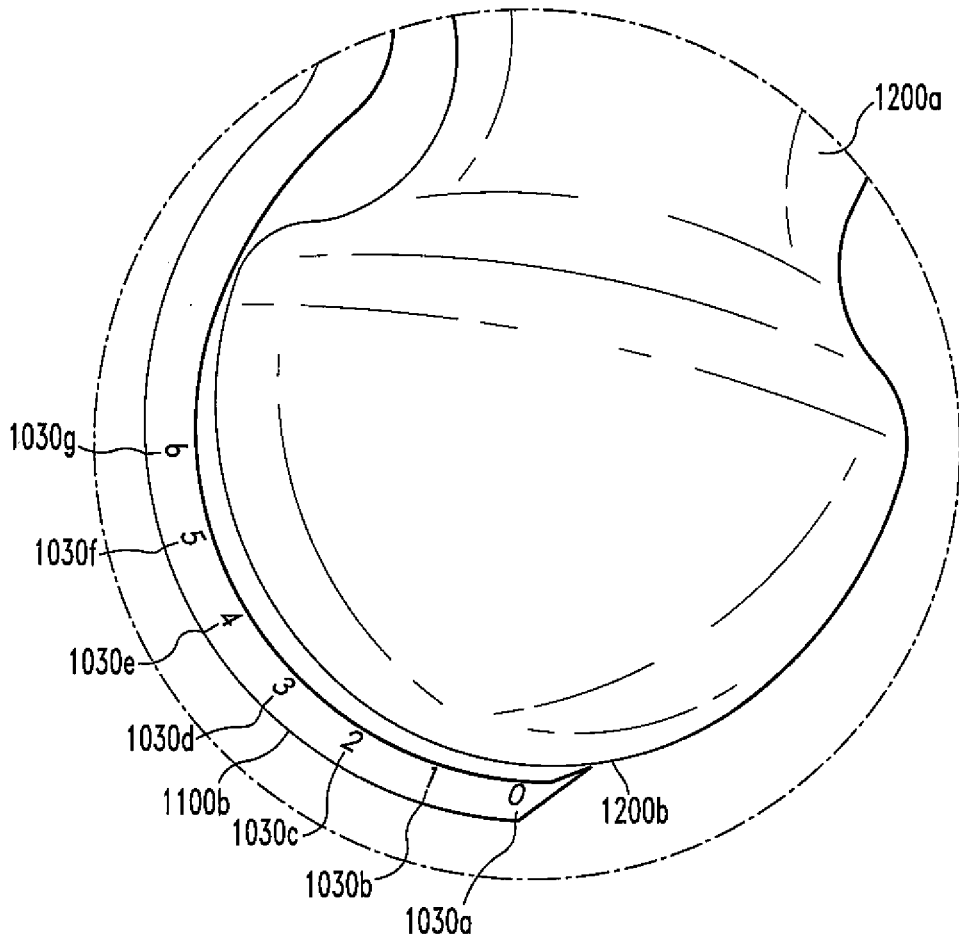

FIG. 14A

MULTIPLE PORTAL GUIDE
CROSS-REFERENCE TO RELATED
APPLICATIONS

[0001] This application is a continuation of U.S. patent application Ser. No. 12/794,142, filed Jun. 4, 2010, which is a continuation-in-part of U.S. patent application Ser. No. 12/032,168, filed Feb. 15, 2008, now U.S. Pat. No. 8,956,278, which claims the benefit of U.S. Patent Application No. 61/015,811, filed Dec. 21, 2007. This application also claims the benefit of 61/187,797, filed Jun. 17, 2009. The disclosures of each of these are incorporated herein by reference in their entireties for all purposes.

BACKGROUND

[0002] Field of Technology

[0003] The present disclosure relates to medical devices for use in surgery and, more specifically, a guide for use in creating multiple portals during surgery.

[0004] Related Art

[0005] During arthroscopic surgery, the joint areas of the body, such as the hip, knee, shoulder, and other joint areas, are approached via the use of an endoscope. Some joints are harder to access than others. For example, the hip joint differs from other joints in that a much thicker layer of soft tissue, known as the hip capsules, surrounds it. This thick layer makes changing the trajectory of instruments placed into the joint difficult and the importance of placing portals, or tissue passages, more critical than other joints.

[0006] Presently, fluoroscopy is used to place the portals that house the endoscope and the other instruments used during surgery. Multiple x-rays are taken while the surgeon tries various approaches to the joint using a thin needle that may be reinserted several times until the ideal portal placement is found. This process exposes the surgical team to radiation, is time consuming, and can lead to trauma, particularly to the delicate articular cartilage and, in the case of the hip joint, the acetabular labrum.

[0007] There is a need for an apparatus and method that would allow for the creation of multiple portals while substantially reducing the possible harmful effects and the amount of time that is required of the present methods.

SUMMARY

[0008] In one aspect, the present disclosure relates to a guide assembly. The assembly includes a guide including a body having a first set of marks and a joint including at least one through hole, the joint configured for sliding along the length of the body, and a first surgical device having a second set of marks. The guide is coupled to the first surgical device and a longitudinal axis of the through hole is co-radial with a mark of the second set of marks when the joint is located at a mark of the first set of marks.

[0009] In another aspect, the present disclosure relates to a guide assembly. The guide assembly includes a guide having a body having at least one through hole and a first surgical device including an end having a mark. The guide is coupled to the first surgical device and a longitudinal axis of the through hole is co-radial with the mark on the end of the first surgical device.

[0010] Further areas of applicability of the present disclosure will become apparent from the detailed description provided hereafter. It should be understood that the detailed

description and specific examples, while indicating the preferred embodiment of the disclosure, are intended for purposes of illustration only and are not intended to limit the scope of the disclosure.

BRIEF DESCRIPTION OF THE DRAWINGS

[0011] The accompanying drawings, which are incorporated in and form a part of the specification, illustrate the embodiments of the present disclosure and together with the written description serve to explain the principles, characteristics, and features of the disclosure. In the drawings:

[0012] FIGS. 1-4 show front views of a first assembly guide of the present disclosure.

[0013] FIG. 5 shows a front view of a second assembly guide of the present disclosure.

[0014] FIG. 6 shows a front view of a third assembly guide of the present disclosure.

[0015] FIG. 7 shows a front view of a fourth assembly guide of the present disclosure.

[0016] FIG. 8 shows an isometric view of a fourth assembly guide of the present disclosure.

[0017] FIG. 9A shows a top view of the lever arm, of the fourth guide assembly, in a first position.

[0018] FIG. 9B shows a top view of the lever arm, of the fourth guide assembly, in a second position.

[0019] FIG. 10 shows a perspective view of the second attachment portion of the fourth guide assembly.

[0020] FIGS. 11A-11D show perspective views of methods for attaching the guides of the present disclosure to an endoscope cannula.

[0021] FIG. 12 shows a front view of the first guide of the present disclosure coupled to an aimer arm.

[0022] FIG. 13 shows a front view of the first guide of the present disclosure coupled to another aimer arm.

[0023] FIG. 14 shows a front view of the fourth guide of the present disclosure coupled to an aimer arm.

[0024] FIGS. 14A shows an expanded view of a distal end of the aimer arm of the guide of FIG. 14.

DETAILED DESCRIPTION OF THE
EMBODIMENTS

[0025] The following description of the preferred embodiment(s) is merely exemplary in nature and is in no way intended to limit the disclosure, its application, or uses.

[0026] FIG. 1 shows a guide 10 that includes a body 11 having a first end 12, a second end 13, an arc along a length L of the body 11, and at least one through hole 14. Also shown in FIG. 1 is a first surgical instrument 20, such as an endoscope, that includes a first end 21 and a second end 22. The second end 13 of the guide 10 is coupled to the first end 21 of the endoscope 20, via a cannula 40, as further described below, and a longitudinal axis 15 of the through hole 14 intersects, or is co-radial with, the second end 22 of the endoscope 20. As also shown in FIG. 1, the body 11 may include multiple through holes 14, each of which includes a longitudinal axis 15 that intersects, or is co-radial with, the second end 22 of the endoscope 20.

[0027] During arthroscopic surgery, especially hip arthroscopy, a first portal 31 is created in a relatively safe position, within a patient's body 32, where damage to internal structures is minimized. The portal 31 may be created via the use of fluoroscopy, as described above, or another method known to those of ordinary skill in the art. The first cannula

40 and endoscope 20 are then inserted through the portal 31, so that a clear view of the inside of the patient's body 32, especially the area 35 where the surgery is to be performed (i.e. the hip joint and the capsule surrounding the joint), can be seen by the surgeon. This view also shows the surgeon the anatomy that must be avoided and where a safe area for placing other portals is. As will be further discussed below, the endoscope 20 is disposed within the first cannula 40 such that the second end 22 of the endoscope 20 protrudes through a second end 42 of the cannula 40. After positioning the second end 22 of the endoscope 20 at an area 36 where the surgeon wishes a second portal (FIG. 4, 33) to be placed, such as the inner surface of the hip capsule, the guide 10 is coupled to the first end 21 of the endoscope 20, via the cannula, and the second portal (FIG. 4, 33) is placed relative to the second end 22 of the endoscope 20 by inserting a second surgical device (FIG. 4, 34), such as a second cannula, through one of the through holes 14 and into the patient's body 32. Since the longitudinal axis 15 of the through hole 14 intersects, or is co-radial with, the second end of 22 of the endoscope 20, the second cannula 34 would also be co-radial with the second end 22 of the endoscope 20. Furthermore, and as will be described below, this co-radial relationship between the second cannula 34 and the second 22 of the endoscope 20 allows a needle or other surgical instrument that may be placed within the second cannula 34 and used in the area 35 described above, to intersect the second end 22 of the endoscope 20.

[0028] Having multiple through holes 14 in the guide 10 allows for flexibility in the placement of the second portal 33 so that damage to internal structures can be minimized. However, a guide 10 having only one through hole 14 may be used.

[0029] FIG. 2 shows the endoscope 20 disposed within the first cannula 40, as described above, such that the second end 22 of the endoscope 20 protrudes through a second end 42 of the cannula 40. The guide 10 is coupled to a first end 41 of the first cannula 40. The cannula 40 has a pointed tip 43, located at the second end 42, which is offset a distance d from the endoscope 20 or in a direction of view 37 of the endoscope 20. As shown in FIG. 2 and in subsequent figures, as described below, the distance d is measured from the optical center 23 of the endoscope 20. The direction of view 37 of the endoscope 20 is located at an angle α , about 70° , relative to a longitudinal axis 26 of the endoscope 20. Sometimes, the anatomy of the body prevents the second end 22 of the endoscope 20 from being positioned in the area 36, such as the inner surface of the hip capsule as described above, where the surgeon wishes the second portal (FIG. 4, 33) to be placed. When this happens, the cannula 40 with the pointed tip 43 can be made to intersect, or be co-radial with, the pointed tip 43. Rather than using a cannula with a pointed tip, the endoscope 20 could be fitted with a pointed tip similar to the pointed tip 43 of the cannula 40. The endoscope 20 and pointed tip could be introduced into the patient's body via slotted cannula.

[0030] FIG. 3 is similar to FIG. 2 in that a longitudinal axis 15 of the through hole 14 intersects with an area 36 that is offset a distance d from the endoscope 20 or in a direction of view 37 of the endoscope 20. However, rather than using the pointed tip 43 of the cannula 40 to identify this area 36, the average distance d between the endoscope 20 and the point of intersection with area 36 is determined and an offset, equal to that average distance d , is built into the guide

10 so that a longitudinal axis 15 of the through hole 14 intersects with this area 36. For example, during hop arthroscopy, a surgeon may want to introduce a needle into the hip capsule 35, but the hip anatomy may prevent the second end 22 of the endoscope 20 from being brought up against the inner surface 36 of the hip capsule. Since the endoscope 20 may be a distance from the capsule inner surface 36, an error where the needle penetrates the capsule would result. To overcome this problem, the pointed tip 43 or the build-in offset d , as described above, could be used. For the purpose of this disclosure, the distance d is about 1 cm. However, the distance d will vary based on the location of the endoscope 20 relative to area 36.

[0031] FIG. 4 shows the second cannula 34 disposed within the through hole 14 and second portal 33. The cannula 34 includes a depth stop 38 that substantially reduces the possibility of a first end 39a of a needle 39 or other surgical instrument, disposed within the cannula 34, from advancing past the second end of the endoscope 20 by having a second end 39b of the needle 39 about a second end 38b of the depth stop 38. The depth stop 38 may be part of the second cannula 34 or separate from the second cannula 34. This allows the second cannula 34 to be positioned to any depth within the through hole 14, yet still have a fixed depth stop relative to the guide 10.

[0032] FIG. 5 shows a guide 60 that includes a body 61 having a first end 62, a second end 63, and an arc along a length L of the body 61. The guide 60 also includes a joint 64 configured for sliding along the length L of the body 61. The joint 64 includes at least one through hole 65. Similar to the guide 10 disclosed in FIGS. 1-4, guide 60 is also coupled to a first surgical device 20, such as an endoscope. The endoscope 20 may be disposed within a first cannula 40, similar to the first cannula disclosed in FIG. 2 and described above, such that the second end 22 of the endoscope 20 protrudes through a second end 42 of the cannula 40. The cannula 40 has a pointed tip 43 similar to the pointed tip shown in FIG. 2 and described above. A second surgical device 34, similar to the second surgical device shown in FIG. 4, is disposed within the through hole 65. A longitudinal axis 66 of the through hole 65, and therefore of the second surgical device 34, intersects, or is co-radial with, the pointed tip 43. However, the longitudinal axis 66 could be made to intersect, or be co-radial with, the second end 22 of the endoscope 20 or with an area 36 that is offset a distance d from the endoscope 20, as shown in FIGS. 1 and 3.

[0033] The joint 64 may be slid along the length L of the body 61 to decide where to place the second portal 33 so that damage to internal structures can be minimized. Since the longitudinal axis 66 of the through hole 65 and the second surgical device 34 is co-radial with the pointed tip 43, a needle or other surgical instrument disposed within the second surgical device 34, will intersect the pointed tip 43, regardless of where the second portal 33 is placed. The joint 64 and the body 61 may include openings 67 to make the guide 60 lightweight and ensure that the joint 64 and the body 61 cool quickly after autoclaving.

[0034] Similar to the guide 60 shown in FIG. 5, FIG. 6 shows a guide 70 that includes a body 71 having a first end 72, and a second end 73. The guide 70 also includes a joint 74 configured for sliding along the body 71. The joint 74 includes at least one through hole 75. Similar to the guide 10 disclosed in FIGS. 1-4, guide 70 is also coupled to a first surgical device 20, such as an endoscope, via a cannula 40.

A second surgical device 34, similar to the second surgical device shown in FIG. 4, is disposed within the through hole 75. A longitudinal axis 76 of the through hole 75, and therefore of the second surgical device 34, intersects, or is co-radial with, an area 36 that is offset a distance d from the endoscope 20. However, the longitudinal axis 76 could be made to intersect, or be co-radial with, a pointed tip 43 of the cannula 40 or the second end 22 of the endoscope 20, as shown in FIGS. 2, 5, 1 and 4.

[0035] As also show in FIG. 5 and described above, the joint 74 may be slid along the body 71 to vary the distance d based upon the distance between the second end 22 of the endoscope 20 and the capsule inner surface 36. Since the second surgical device 34 is co-radial with the area 36, a needle or other surgical instrument disposed within the second surgical device 34, will intersect the area 36, regardless of where the second portal 33 is placed. The guide 70 also includes a mechanism 77, such as a locking nut, for engaging the joint 74 and holding it in a position along the body 71. Once the surgeon has determined the position of the second portal 33, the locking nut 77 will be tightened to engage the joint 74 and hold it in a position along the body 71. The second surgical device 34 will then be inserted into the through hole 75 and through the patient's body 32 to make the second portal 33.

[0036] Similar to the guides 60,70 show in FIGS. 5 and 6, the guide 80 shown in FIG. 7 includes a body 81 having a first end 81a, a second end 81b, and an arc along a length L of the body 81. The guide 80 also include a joint 84 configured for sliding along a length L of the body 81. The joint 84 includes at least one through hole 85. Similar to the guide 10,60,70 disclosed in FIGS. 1-6, guide 80 is also coupled to a first surgical device 20, such as an endoscope via the first end 21 of the endoscope 20 and the first end 41 of the cannula 40. A second surgical device 34, similar to the second surgical device shown in FIGS. 4-6, is disposed within the through hole 85. A longitudinal axis 86 of the through hole 85, and therefore of the second surgical device 34, intersects, or is co-radial with, the second end 22 of the endoscope 20. However, the longitudinal axis 86 could be made to intersect, or be co-radial with, a pointed tip 43 of the cannula 40 or an area 36 that is offset a distance d from the endoscope 20, as shown in FIGS. 4, 5, and 3.

[0037] As also shown in FIG. 7 and described above, the joint 84 may be slid along the length L of the body 81 to decide where to place a second portal so that damage to internal structures can be minimized. Since the second surgical device 34 is co-radial with the second end 22 of the endoscope 20, a needle 90 or other surgical instrument disposed within the second surgical device 34, will intersect the second end 22, regardless of where the second portal is placed. The body 80 includes a slot 81c that runs the entire length L of the body 80 and that houses the joint 84. In addition, similar to the guide 70 of FIG. 6, the guide 80 includes a mechanism 87, such as a locking nut, for engaging the joint 84 and holding it in a position along the body 81. During surgery, use of the locking nut 87 in creating a second portal occurs in the same manner as described above. After the second surgical device 34, or second cannula, has been inserted into the patient's body, the needle 90, or other instrument, may be inserted through the cannula 34 for use in performing a surgical procedure. The needle 90 which intersects, or is co-radial with, the second end 22 of the endoscope 20, may include a depth stop 90c, at a first end

90a of the needle 90, that abuts a first end 34a of the cannula 34 to substantially reduce the possibility of the second end 90b of the needle 90 from advancing past the second end 22 of the endoscope 20.

[0038] As show in FIGS. 7 and 8, the guide 80 includes a first attachment portion 88 and a second attachment portion 89, both of which are configured for coupling the body 81 to the first surgical device 20 via the first surgical device 20 and the cannula 40. The first attachment portion 88, which includes an anti-rotation lock, is located at the first end 81a of the body 81 and extends substantially perpendicular to the axis 26 of the endoscope 20. As shown in FIGS. 9A and 9B, the anti-rotation lock 88 includes a lever arm 88c located between a top surface 88a and bottom surface 88b of the anti-rotation lock 88. The lever arm 88c is coupled to the surfaces 88a,b via a pivot pin or screw 88d and a spring 88e. When the endoscope 20 is not coupled to the anti-rotation lock 88, the level arm 88c is in a first position, as shown in FIG. 9A, such that the spring 88e is in a relaxed state. However, when the endoscope 20 is coupled to the anti-rotation lock 88, the lever arm 88c is in a second position, as shown in FIG. 9B, such that the lever arm 88c is pushed against the light post 24 of the endoscope 20, and substantially reduces the possibility of rotation of the light post 24 in a direction that would uncouple the cannula 40 from the endoscope 20.

[0039] As show in FIGS. 7 and 8, the second attachment portion 89 is located near the second end 81b of the body 81 and extends substantially perpendicular to the longitudinal axis 26 of the endoscope 20. The portion 89 includes two prongs 89a,b, both of which extend longitudinally from the portion 89, and an opening 89c, located between the prongs 89a,b that extends longitudinally into the portion 89. As shown in FIG. 10, the cannula 40 includes a coupling portion 45 configured for coupling of the second attachment portion 89 to the cannula 40. The coupling portion 45 includes two holes 45a and a projection 45b that extends longitudinally from the coupling portion 45. The second attachment portion 89 is coupled to the coupling portion 45 such that the prongs 89a,b are disposed with the holes 45a and the projection 45b is disposed within the opening 89c.

[0040] As shown in FIG. 7, the second end 81b of the body 81 does not extend beyond a plane 90, located between the second attachment portion 89 and a longitudinal axis 26 of the first surgical device 20, and that forms an angle β , about 60° , with the longitudinal axis 26.

[0041] FIGS. 11A-11D show methods for coupling the second end 13 of the guide 10 to the first end 41 of the cannula 40. As shown in FIG. 11A, the second end 13 includes a first arm 13a, a second arm 13b, and a slot 13c located between the first and second arms 13a,b. The first end 41 of the cannula 40 includes a coupling portion 46, similar to the coupling portion 45 shown in FIG. 10 albeit with channels 46a instead of holes 45a. The second end 13 of the guide 10 is coupled to the first end 41 of the cannula 40 such that the first and second arms 13a,b are housed within the channels 46a and the projection 46b is housed within the slot 13c. Both arms 13a,b include an edge 13a', 13b', wherein each edge 13a', 13b', is configured for attaching to the backside 46c of the coupling portion 46 when the guide 10 is coupled to the coupling portion 46, therefore creating a snap-fit connection between the arms 13a,13b, and the coupling portion 46.

[0042] As shown in 11B, the second end 13 of the guide 10 includes a first arm 13a and a second arm 13b. The first end 41 of the cannula 40 includes an adaptor 47 that has been slid over the cannula 40. The first and second arms 13a,b of the guide 10 are coupled to the adaptor 47 such that an interference fit, or a clip-on connection is created between the arms 13a,b and the adaptor 47.

[0043] As show in 11C, the second end 13 of the guide 10 includes a base portion 13d that partially surrounds the first end 41 of the cannula 40 and includes a hook 13e that is placed on the irrigation extender 50, which is coupled to the cannula 40. Shown in FIG. 11D is a guide 10 that includes a second end 13 having an arm 13f including an opening 13f' and a slot 13f'' formed in the arm 13f. The first end 41 of the cannula 40 includes a coupling portion 49, similar to the coupling portions 45, 46 shown in FIGS. 10 and 11A, albeit without holes or channels. The second end 13 of the guide 10 is coupled to the first end 41 of the cannula 40 such that the first end 41 of the cannula 40 is disposed within the opening 13f' and the projection (not shown) is housed with the slot 13f''. The guide 10 may be placed onto the first end 41 by placing the opening 13f' over the first end 41 and sliding the arm 13f and the first end 41. Other methods of coupling the guide to the cannula may also be used.

[0044] As show in FIG. 12, a guide 100, similar to the guide 10 in FIGS. 1-4, is coupled to a first surgical device 200, such as an aimer arm, that includes a distal end 200b in the shape of a hook. The distal end 200b of the aimer arm 200 is positioned in the posterior region 300b of the hip joint 300. A second surgical device 400, such as a cannula, is disposed within the through hole 104 of the guide 100. A longitudinal axis 401 of the cannula 400 is co-radial with the tip B200cB on the distal end 200b of the aimer arm 200. This co-radial relationship allows access to the posterior region 300b of the hip joint 300, via the femoral neck 300a, by a surgical tool, such as a drill (not shown), disposed within the cannula 400. The aimer arm 200 may be introduced into the body 32 in the same manner as the endoscope 20 is introduced, as described above, or another manner known to one of ordinary skill in the art. Likewise, the guide 100 may be coupled to the aimer arm 200 in the same manner as guide 80 is coupled to the cannula 40 in FIG. 7, in the same manner as guide 10 is coupled to the cannula 40 in FIGS. 11A-11D, or another manner known to one of ordinary skill in the art. The aimer arm 200 may rotate around a longitudinal axis 201 of the aimer arm 200 via a rotational coupling (as shown) located at the proximal end 200a of the aimer arm 200.

[0045] As shown in FIG. 13, a guide 500, similar to the guide 100 in FIG. 12, is coupled to a first surgical device 600, such as an aimer arm, that includes a distal end 600b in the shape of a hook. The distal end 600b of the aimer arm 600 is positioned in the posterior region 700b of the hip joint 700. A second surgical device 800, such as a cannula, is disposed within the through hole 504 of the guide 500. A longitudinal axis 801 of the cannula 800 is co-radial with the mark 600c on the distal end 600b of the aimer arm 600. This co-radial relationship allows access to the posterior region 700b of the hip joint 700, via the femoral neck 700a, by a surgical tool, such as a drill (not shown), disposed within the cannula 800. The aimer arm 600 may be introduced into the body in the same manner as the endoscope 20 is introduced, as described above, or another manner known to one of ordinary skill in the art. Likewise, the guide 500 may be

coupled to the aimer arm 600 in the same manner as guide 10 is coupled to the cannula 40 in FIGS. 11A-11D, or another manner known to one of ordinary skill in the art. Furthermore, the mark 600c, which may be created by a laser or any other technology that could be used to create the mark, may be located anywhere along the hook 600b. Mark 600c may also be a physical feature, such as a bump, a hole, or any other physical feature that may be seen on an X-ray.

[0046] As shown in FIGS. 14 and 14A, a guide 100, similar to the guide 80 in FIG. 7, is coupled to a first surgical device 1100, such as an aimer arm, that includes a distal end 1100b in the shape of a hook. The distal end 1100b of the aimer arm 1100 is positioned in the posterior region 1200b of the hip joint 1200. A second surgical device 1300, such as a cannula, is disposed within the through hole 1010a of the joint 1010. The guide 1000 includes a first set of marks 1020a-1020g and the distal end 1100b of device 1100 includes a second set of marks 1030a-1030g, as more clearly shown in FIG. 14A. A mark of the first set of marks 1020a-1020g and a mark of the second set of marks 1030a-1030g are co-radial. For example, as shown in FIG. 14, the longitudinal axis 1400 of device 1300 is co-radial with mark 1030g when joint 1010 is located at mark 1020g. This co-radial relationship allows access to the posterior region 1200b of the hip joint 1200, via the femoral neck 1200a, by a surgical tool, such as a drill (not shown), disposed within the cannula 1300. During use, the joint 1010 is moved to a mark or marker of the first set of marks 1020a-1020g and the drill (not shown) is then inserted into the cannula 1300.

[0047] The aimer arm 1100 may be introduced into the body in the same manner as the endoscope 20 is introduced, as described above, or another manner known to one of ordinary skill in the art. Likewise, the guide 1000 may be coupled to the aimer arm 1100 in the same manner as guide 10 is coupled to the cannula 40 in FIGS. 11A-11D, or another manner known to one of ordinary skill in the art. Furthermore, the marks 1020, 1030 may be created by a laser or any other technology that could be used to create the marks.

[0048] For the purpose of this disclosure, a manual or automatic milling machine is used to create the through holes of the guides described above. Other apparatuses and methods of creating the through holes may also be used. The guides are manufactured from a metal material, such as stainless steel or titanium, by may be manufactured from another material known to one of ordinary skill in the art. In addition, the first and second cannulas and the aimer arm described above are manufactured from another biocompatible material known to one of ordinary skill in the art. Furthermore, for purposes of this disclosure, the guides include a body having an arc along the length of the body, but an arc is not necessary and the body may be straight or incorporate any other shapes known to one of ordinary skill in the art. Although the present disclosure relates to the use of the above described guides for the placement of portals during hip arthroscopy, the basic principles and methods may also be applied to other joint areas of the body.

[0049] As various modifications could be made to the exemplary embodiments, as described above with reference to the corresponding illustrations, without departing from the scope of the disclosure, it is intended that all matter contained in the foregoing description and shown in the accompanying drawings shall be interpreted as illustrative rather than limiting.

What is claimed is:

1. A guide assembly comprising:
 - a guide including a body having at least one through hole; and
 - a first surgical device coupled to the guide and having a distal portion configured to engage a bone surface;
 - wherein the through hole is configured to receive a second surgical device therethrough;
 - wherein a longitudinal axis of the through hole is co-radial with an aiming feature defined by the distal portion of first surgical instrument; and
 - wherein the distal portion of the first surgical instrument intersects with and extends beyond the longitudinal axis of the through hole.
2. The guide assembly of claim 1, wherein the first surgical device is an aimer arm.
3. The guide assembly of claim 1, wherein the aiming feature is one of a laser mark, a bump, or a hole.
4. The guide assembly of claim 1, further comprising one or more depth limiting elements configured to limit movement of a distal end of the second surgical instrument beyond the distal portion of the first surgical instrument.
5. The guide assembly of claim 1, wherein the distal portion of the first surgical device is contoured to substantially conform to a curved bone surface.
6. The guide assembly of claim 5, wherein the distal portion defines a curved surface, the curved surface configured to correspond with a curvature of a femoral head so as to enable engaging the curved surface with the femoral head.
7. The guide assembly of claim 6, wherein the longitudinal axis of the through hole is configured to guide access of the second surgical device to a region of the hip joint via a path through the femoral neck.
8. The guide assembly of claim 1, wherein the through hole is defined by a joint which is slidable along a length of the body, wherein a first longitudinal axis of the through hole is defined for a first position of the joint and a second longitudinal axis of the through hole is defined for a second position of the joint, the first and second longitudinal axes of the through hole being co-radial with different aiming features defined by the distal portion of the first surgical device and intersecting with one another at a point in between the guide and the first surgical device, wherein the distal portion

of the first surgical instrument intersects with and extends beyond both the first and second longitudinal axis of the through hole.

9. The guide assembly of claim 8, wherein the first longitudinal axis of the through hole and the second longitudinal axis of the through hole are configured to guide access of the second surgical device to a region of the hip joint via different paths through a femoral neck when the first surgical device is engaged with a femoral head and the second surgical device is received in the through hole.

10. The guide assembly of claim 1, further comprising a second surgical device disposed within the through hole.

11. The guide assembly of claim 10, wherein the second surgical device is a cannula.

12. The guide assembly of claim 11, wherein the cannula is configured to receive a drill.

13. The guide assembly of claim 1, wherein the guide is removably coupled to the first surgical device.

14. The guide assembly of claim 7, wherein the longitudinal axis of the through hole is configured to align with an axis of the femoral neck when the first surgical device is engaged with the femoral head.

15. The guide assembly of claim 7, wherein the second longitudinal axis of the through hole is configured to be at an angle relative to an axis of the femoral neck when the first surgical device is engaged with the femoral head.

16. The guide assembly of claim 1, wherein the distal tip of the first surgical device includes a pointed spike for engaging with the bone.

17. The guide assembly of claim 1, wherein the guide includes multiple through holes each through hole defining a longitudinal axis different from the longitudinal axes of the other through holes.

18. The guide assembly of claim 17, wherein the longitudinal axes of the through holes are co-radial with respect to a same aiming feature defined by the distal portion of the first surgical device.

19. The guide assembly of claim 17, wherein the longitudinal axes of the through holes are co-radial with respect to different aiming features defined by the distal portion of the first surgical device.

* * * * *